

## PART No: TLLS-N3

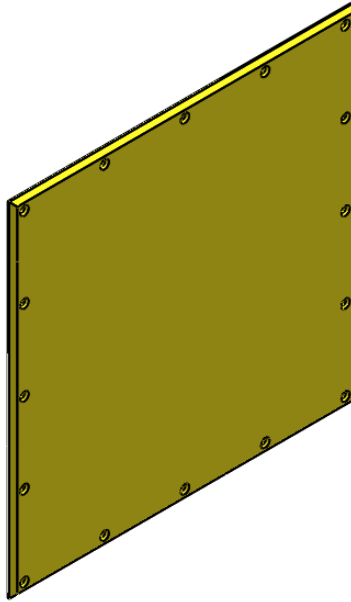

Where trailers are left disconnected from their cab units, landing legs can cause severe damage to your floor. Our Trailer Landing Leg Supports are designed to spread the load over a wider area and help prevent such damage.

MATERIAL	Polyethylene (UHMWPe)
WEIGHT	18.5Kg
ESTIMATED LEADTIME	1-2 weeks
OPTIONAL EXTRAS	TLLS-F1 - Fixings for concrete M10 x 100 Countersunk Safety+ Bolt

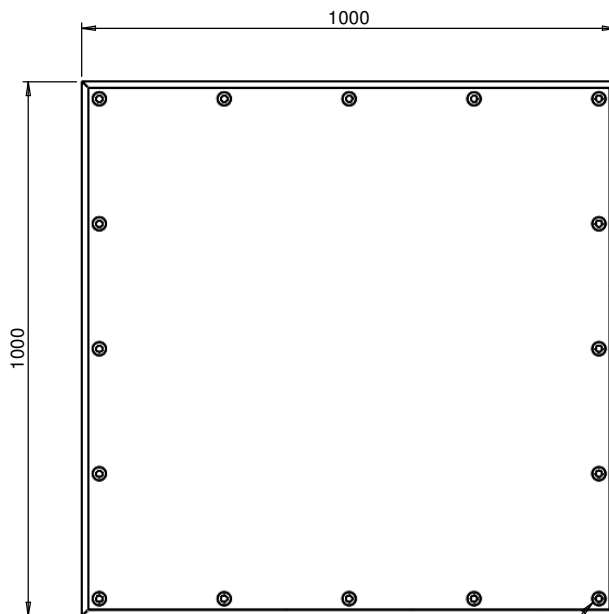

Includes 16 off CSK holes  
for M10 Safety+ fixings

All dimensions shown are in millimetres and are intended for reference purposes only;  
exact product measurements may vary due to applied tolerances and methods of manufacture

